

# alethia™

Mycoplasma Direct

## TEST PROCEDURE

How to perform the test



1. Store throat swab sample in a suitable non-nutritive transport medium with pledget (Liquid Amies, without charcoal, or Liquid Stuart).



2. Insert single swab into SMP PREP, breaking the swab handle. Recap the SMP PREP and vortex 10 seconds.



3. Squeeze 5-10 drops of sample into Heat Treatment Tube.



4. Incubate the Heat Treatment Tube at 95 C for 10 minutes. Vortex for 10 seconds.

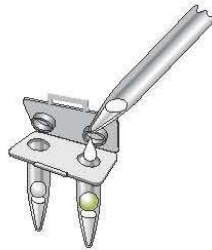

5. Using a micropipette, transfer 50 µL of heat-treated sample to the (Left) TEST Chamber, then transfer 50 µL to the (Right) CONTROL Chamber of the Alethia™ Test Device.

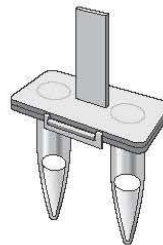

6. Close and fasten the latch securely. Gently tap each device to remove air bubbles trapped on the bottom of the tubes. Carefully examine reaction tubes to ensure there are no air bubbles left in the tubes.



7. Insert the Alethia™ test device into the Alethia™ instrument and initiate amplification reaction and detection.



This illustration is representative of the current Package Insert at the time of publication. Please refer to the most current version of the Package Insert for complete instructions.

### USA/CORPORATE OFFICE

3471 River Hills Drive  
Cincinnati, Ohio 45244 USA  
Telephone: 513-271-3700

©2018 SNT040 REV. 08/18

### MERIDIAN BIOSCIENCE EUROPE

Belgium/Luxembourg Tel: +32 (0)6789 5959  
France Tel: +33 (0)1 4256 0440  
Germany Tel: +49 (0)3371 60 222 31  
Italy Tel: +39 0331 43 3636  
Netherlands Tel: +31 (0)411 62 11 66  
United Kingdom Tel: +44 (0)20 8463 7970

Orders/Customer Service: 1-800-543-1980  
Technical Support: 1-800-343-3858  
Information Fax: 513-272-5432  
Ordering Fax: 513-271-0124  
[meridianbioscience.com](http://meridianbioscience.com)

**meridian** BIOSCIENCE™